

PHILIPS OPTICAL STORAGE

Replacement Instructions

Turntable Cone

CD-Pro 2

Preface

This document describes the handling instructions for replacement of the solid turntable cone in the CD-Pro(2) products.



INSTRUCTIONS

1. PREPARATIONS

Important:

Follow the general handling instructions for CD-Pro(2)

Take appropriate measures against ESD

Tools:

Use a pair of small screwdrivers (2 mm blade width max)

Working position:

Place the unit in front of you as indicated in fig 1. – **Do not touch the lens**

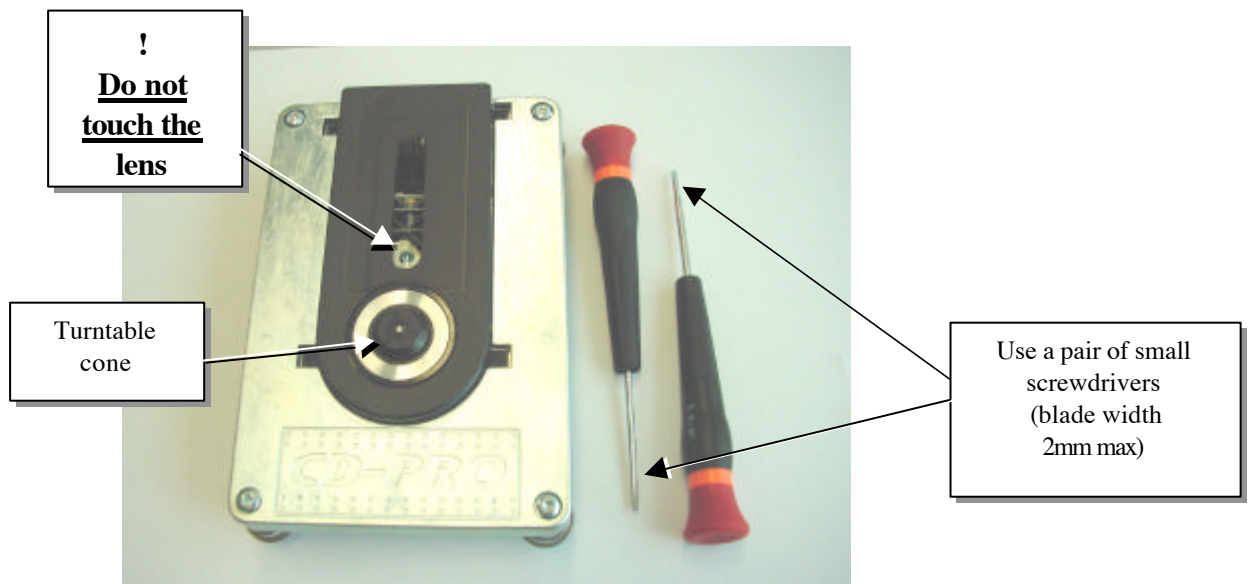

Figure 1

2. REMOVING THE TURNTABLE CONE

See Fig. 2:

- Insert the screwdrivers into the small slots at either side of the turntable cone
- Carefully move the screwdriver handles **upward** simultaneously to lift-off the cone.

Important:

Do **NOT** move screwdrivers **downward** to avoid turntable damage.

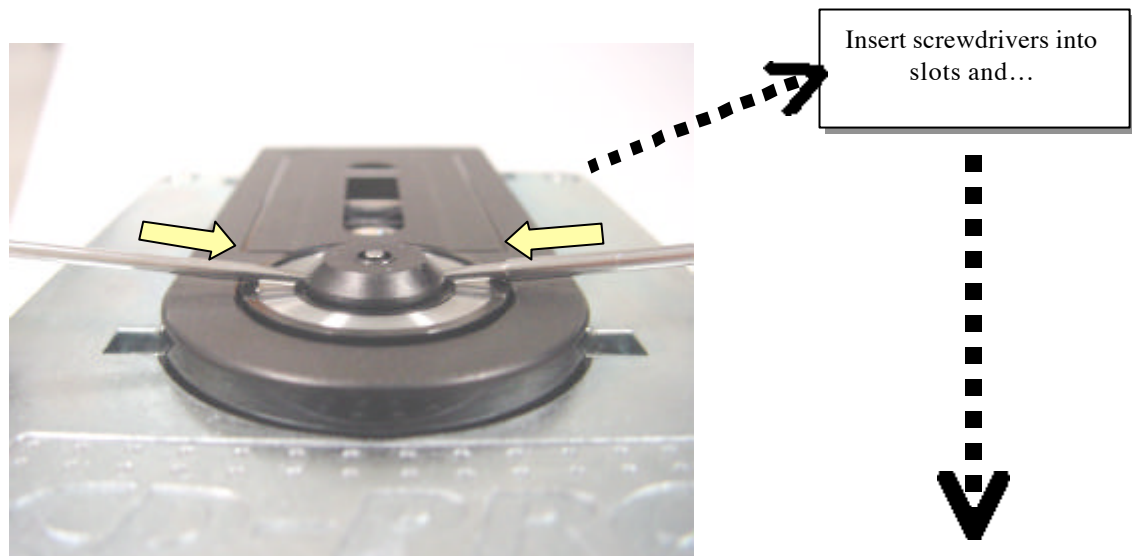

Figure 2a.

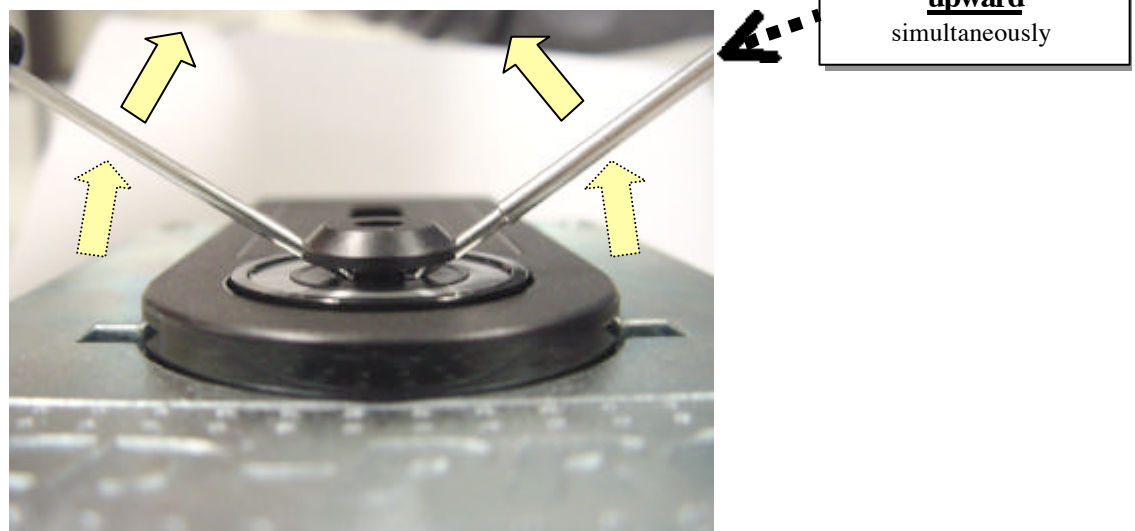

Figure 2b.

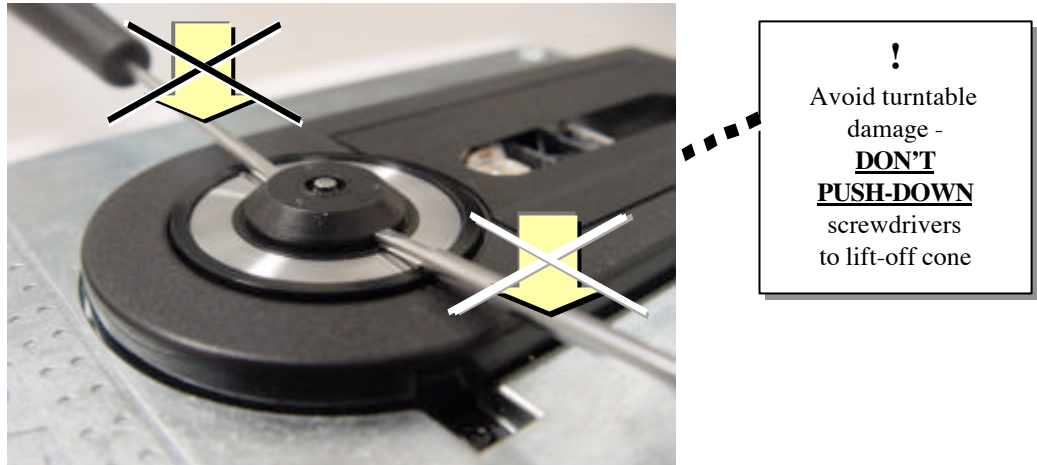

Figure 3

3. MOUNTING TURNTABLE CONE

See Fig. 4

- Place the new turntable cone over the turntable shaft.
- Do NOT apply any glue.**
- Push cone down gently until it touches the turntable surface.

Important:

Do NOT exceed maximum force allowed to turntable.

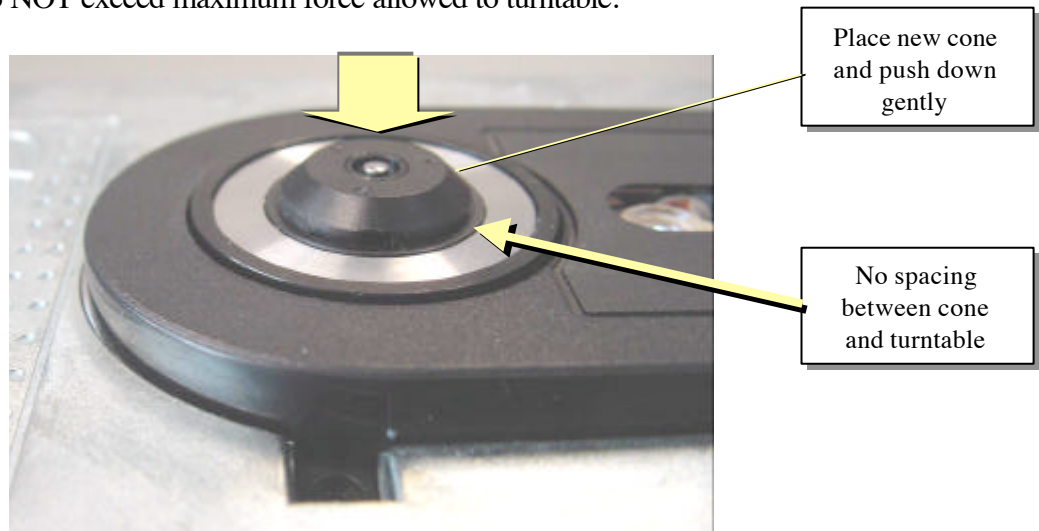

Figure 4

4. PROBLEM SOLVING

Symptom: CD slips during spinning-up or braking.

Cause: The disc is not clamped sufficiently.

Remedy: Push down the cone until it touches the turntable surface.

Symptom: CD-PRO(2) does not play correctly.

Cause: Turntable pushed down/max force to turntable exceeded.

Remedy: Replace CD-PRO(2) mechanism.